

The Boathouse Business Centre

1 Harbour Square, Nene Parade, Wisbech, PE13 3BH

Ground Floor Availability - September 2024

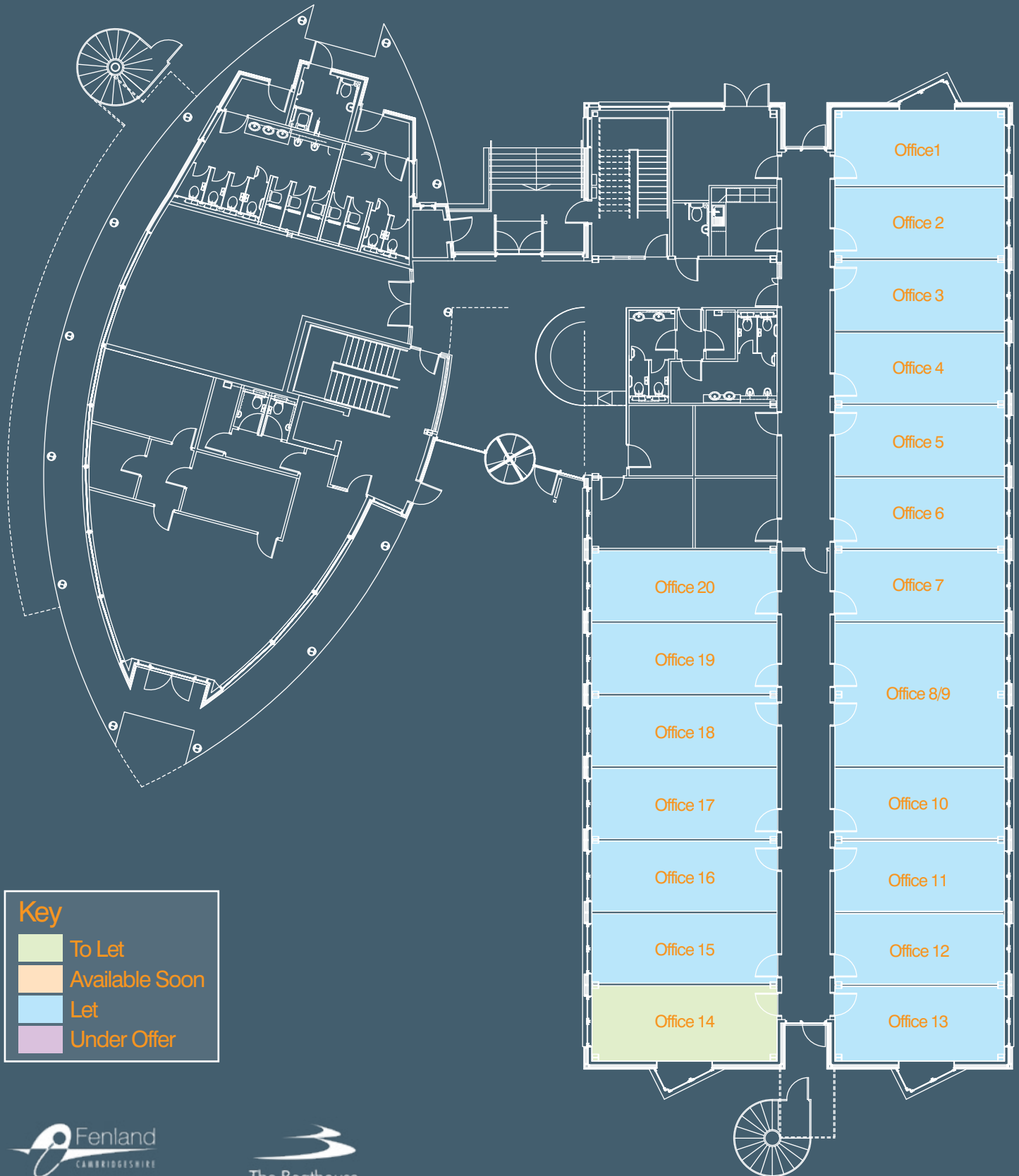

The Boathouse Business Centre

1 Harbour Square, Nene Parade, Wisbech, PE13 3BH

First Floor Availability - September 2024

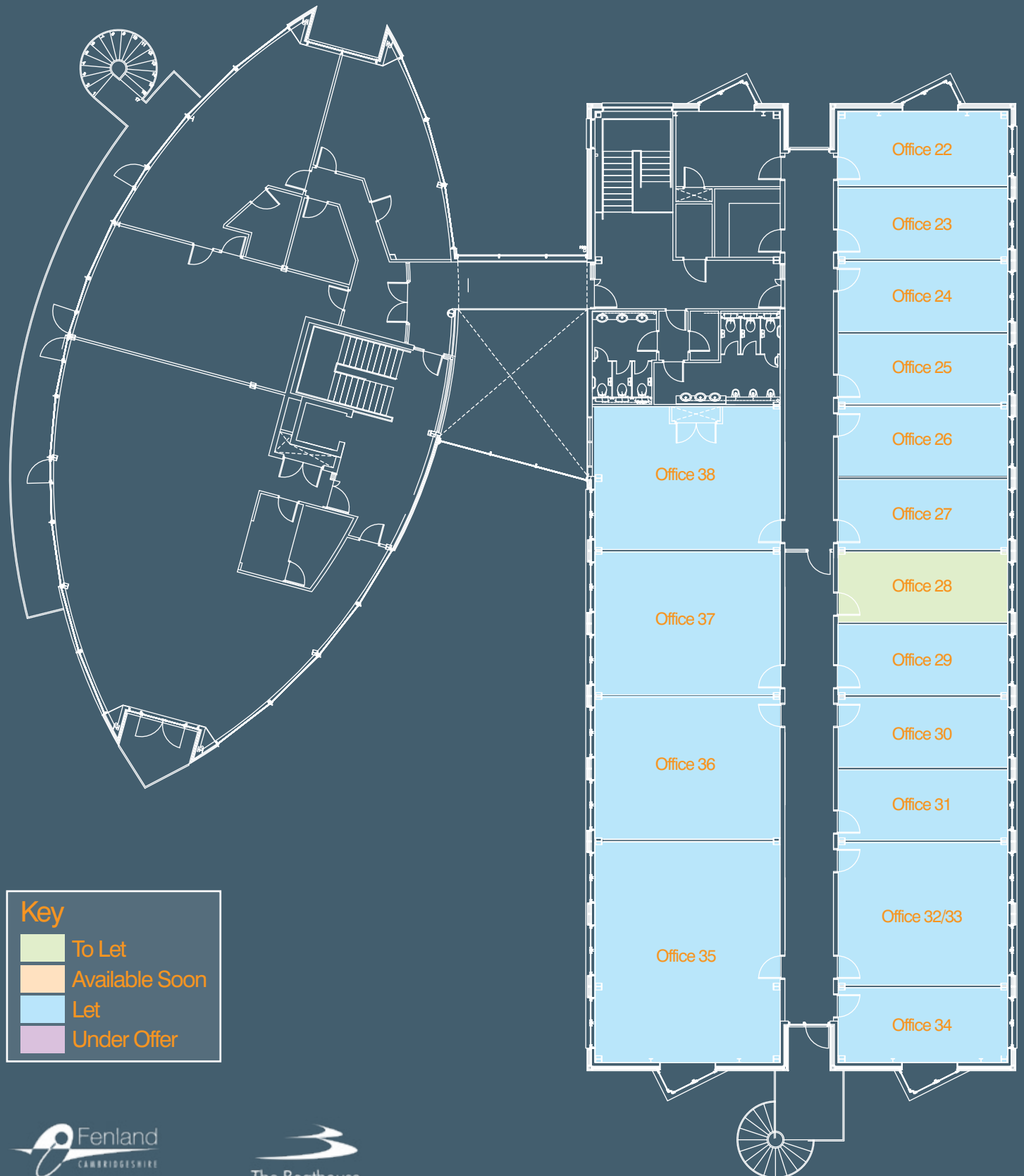

The Boathouse Business Centre

1 Harbour Square, Nene Parade, Wisbech, PE13 3BH

Room Size and Rent Costs - September 2024

| Office No. | Net Area (m ²) | Net Area (ft ²) | Rent (£/ft ²) | Rent (£/p.a.) | Rent (£p/m.) |
|------------|----------------------------|-----------------------------|---------------------------|---------------|--------------|
| Office 14 | 23.25 | 250 | £21.85 | £5,467.64 | £455.64 |
| Office 28 | 19.63 | 211 | £21.85 | £4,617.22 | £384.77 |

To register your interest please contact **07935 014469**

Key

 To Let  Available Soon  Under Offer

Note: Rent is subject to VAT at the prevailing rate