

The Boathouse Business Centre

1 Harbour Square, Nene Parade, Wisbech, PE13 3BH

Ground Floor Availability - May 2025

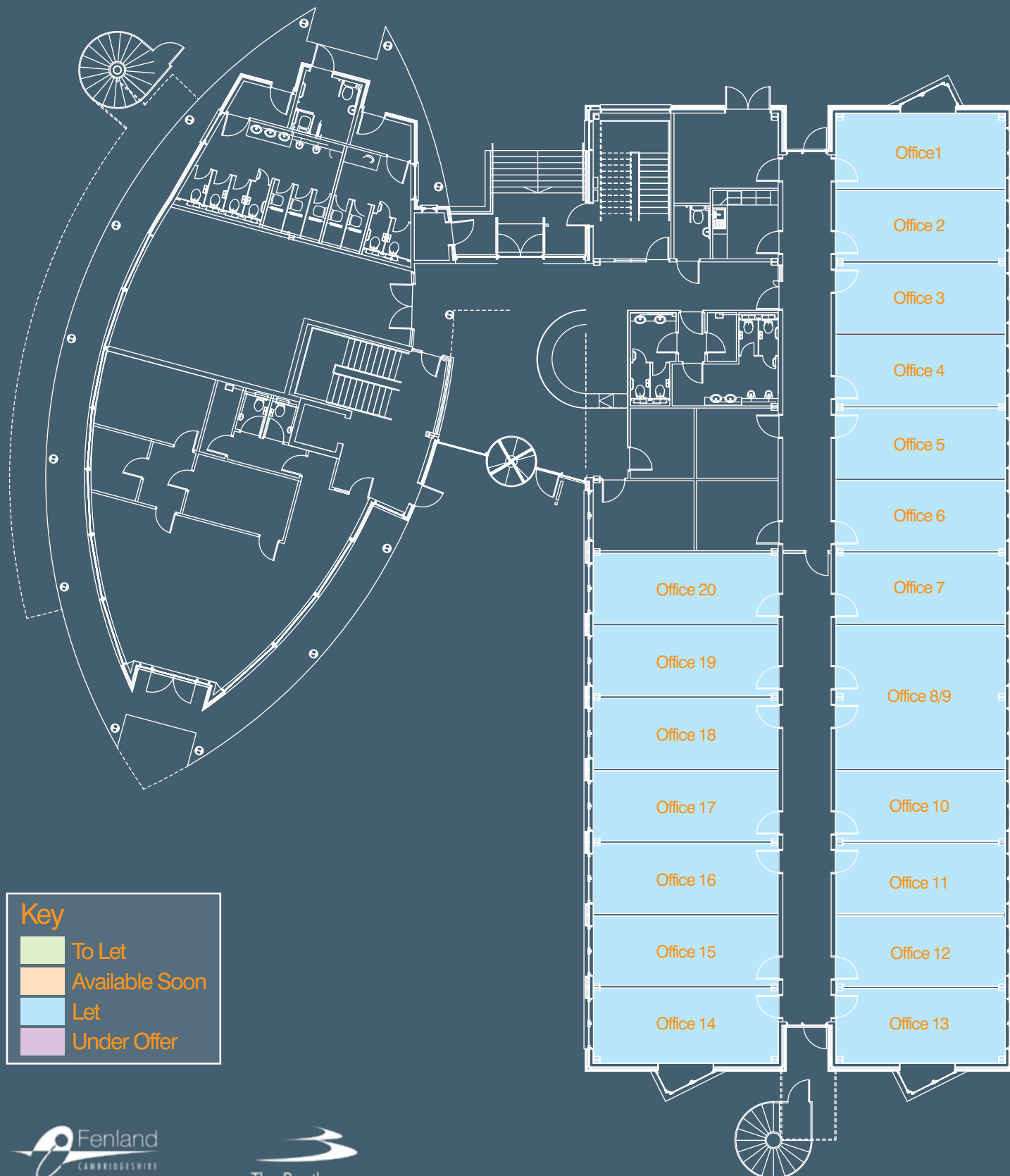

The Boathouse Business Centre

1 Harbour Square, Nene Parade, Wisbech, PE13 3BH

First Floor Availability - May 2025

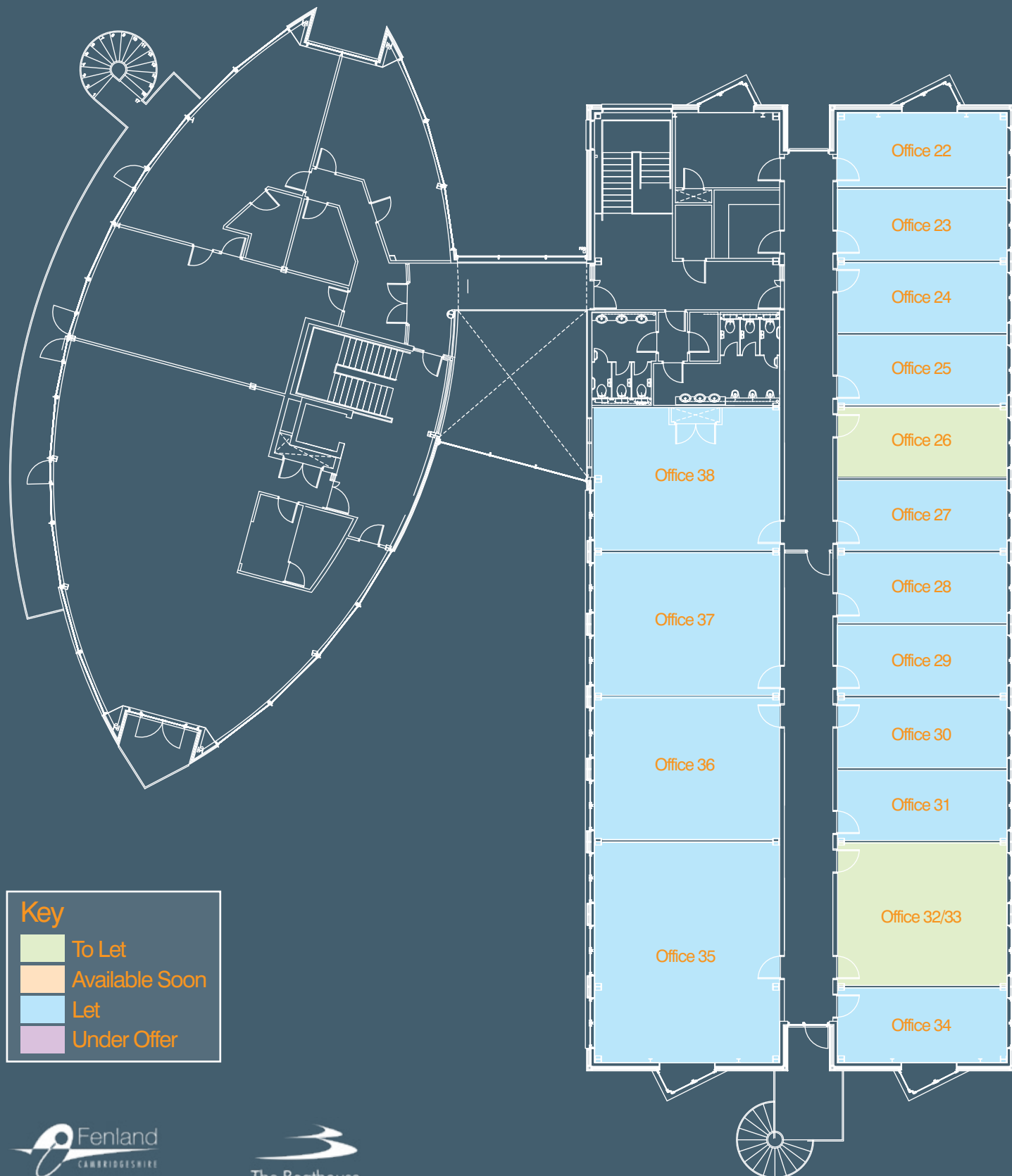

The Boathouse Business Centre

1 Harbour Square, Nene Parade, Wisbech, PE13 3BH

Room Size and Rent Costs - May 2025

| Office No. | Net Area (m ²) | Net Area (ft ²) | Rent (£/ft ²) | Rent (£/p.a.) | Rent (£p/m.) |
|------------|-------------------------------|--------------------------------|------------------------------|------------------|-----------------|
| Office 26 | 19.80 | 213 | £21.85 | £4,656.59 | £388.05 |
| Office 32 | 19.82 | 213 | £21.85 | £4,660.47 | £388.37 |
| Office 33 | 19.82 | 213 | £21.85 | £4,661.25 | £388.44 |
| Office 39 | 47.20 | 508 | £24.00 | £12,192.00 | £1,016.00 |

To register your interest please contact 07935 014469

Key

 To Let  Available Soon  Under Offer

Note: Rent is subject to VAT at the prevailing rate