

The Boathouse Business Centre

1 Harbour Square, Nene Parade, Wisbech, PE13 3BH

Ground Floor Availability - August 2025

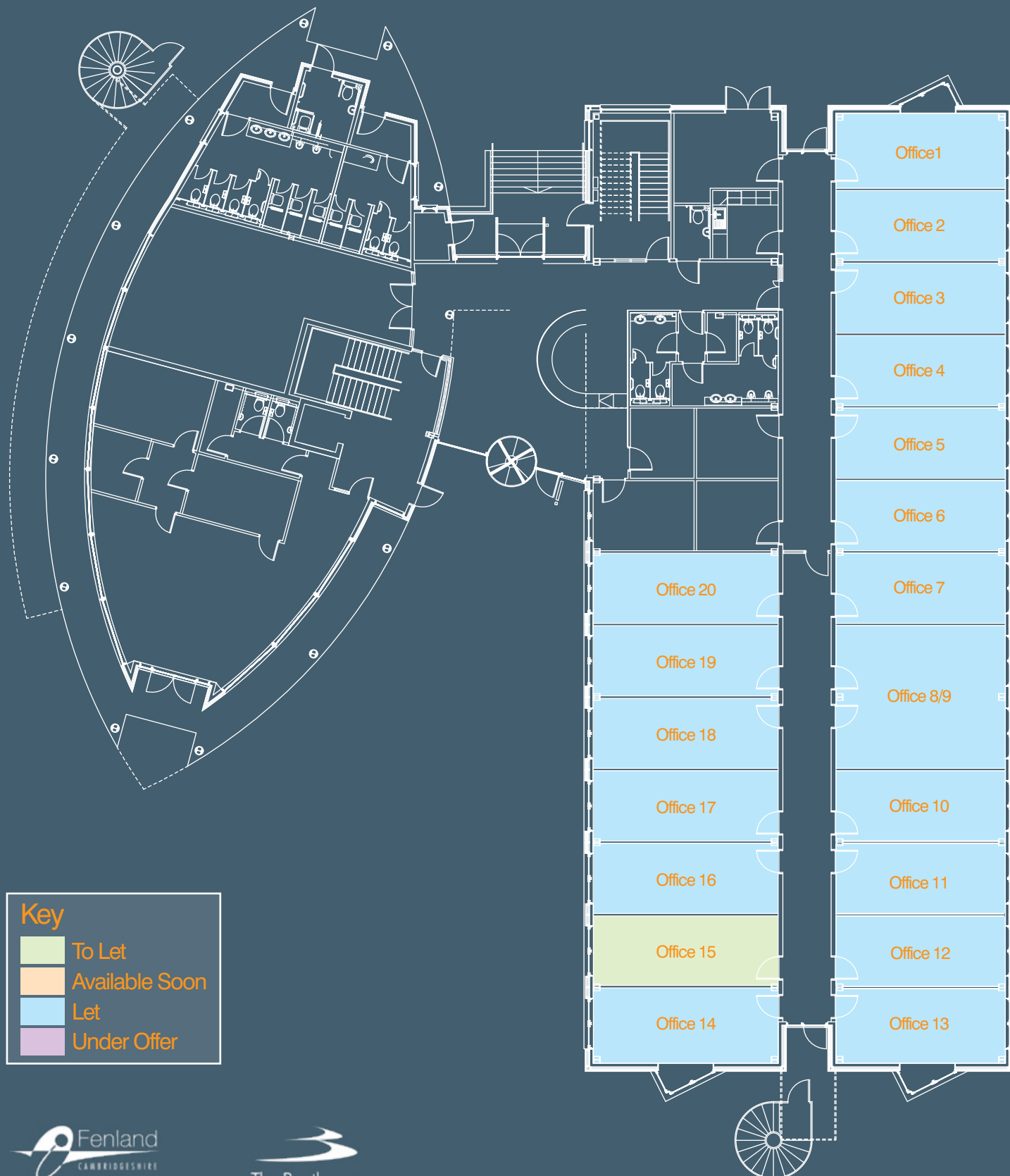

The Boathouse Business Centre

1 Harbour Square, Nene Parade, Wisbech, PE13 3BH

First Floor Availability - August 2025

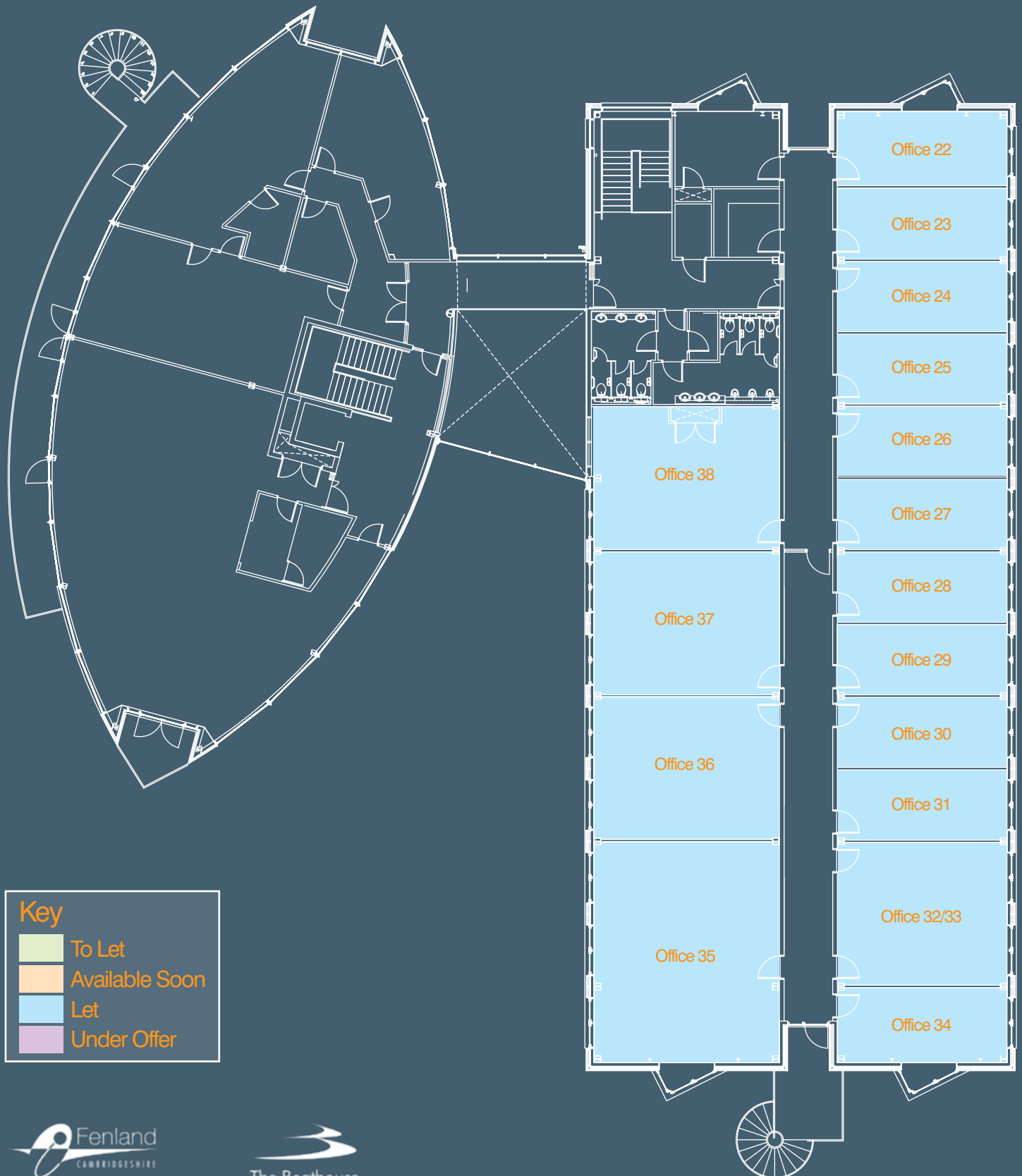

The Boathouse Business Centre

1 Harbour Square, Nene Parade, Wisbech, PE13 3BH

Room Size and Rent Costs - August 2025

Office No.	Net Area (m ²)	Net Area (ft ²)	Rent (£/ft ²)	Rent (£/p.a.)	Rent (£p/m.)
Office 15	22.05	237	£22.86	£5,417.88	£451.49

To register your interest please contact 07935 014469

Key

 To Let  Available Soon  Under Offer

Note: Rent is subject to VAT at the prevailing rate